

SB04

Flow Limiters Flange Mounted

- **Flow quantity control without additional power requirements**
- **Energy saving by limiting the flow of liquids to the necessary flow rate**
- **For DIN/ASME flange PN16/300 lbs DN40...DN100**
- **Simple mounting between 2 flanges**
- **All metal design without plastic internals**
- **Material: stainless steel**
- **Pmax: 10 bar, Tmax: 200 °C**



Description:

The Flow limiters SB04 are developed to limit the flow of a liquid media to a certain amount. They assure that the flow amount will not exceed even by fluctuating inlet or outlet pressures.

In contrast to the most customary devices of this type the flow limiters SB04 have a spring element made of stainless steel instead of a usual plastic membrane.

Due to the differential pressure across the limiter this variable orifice changes its aperture continuously. Through increasing the orifice size with falling pressure or decreasing it with rising pressure the flow rate will always remain constant.

Typical application:

For water and watery media. Usable in water distribution systems in the industry, in car wash installations, for sanitary applications and in water treatment systems.

Method of operation and composition:

see data sheet SB02

Flow volumes:

The individual elements can be used for all flow rates from 1...30 l/min water in steps of 1 l/min each.

By adding several flow elements on to a common disc nearly all flow rates may be realized.

Technical Data:

min. control pressure:	2 bar
max. working pressure:	10 bar
max. media-temperature:	200 °C
accuracy for 1...30 l/min:	
bis 2 l/min:	± 15 % of flow value
ab 3 l/min:	± 10 % of flow value

Materials:

Stainless steel version:	device body:	1.4305
	regulating star:	1.4310
	cone:	1.4301
	rivet:	1.4301
	retaining ring:	1.4122

Order Code:

Order number	SB04.	2.	40DA.	100.	0
Flow limiters					
Disc material	2 = disc stainless steel, inserts stainless steel				
Disc / nominal sizes:	40DA = DN 40 DIN/ASME 50D = DN 50 DIN 50A = DN 50 ASME 65DA = DN 65 DIN/ASME 80D = DN 80 DIN 80A = DN 80 ASME 100D = DN 100 DIN 100A = DN 100 ASME				
Flow rate:	xxx = in l/min water				
Options:	0 = without 1 = please specify in plain text				

Versions and dimensions:

The flow limiters are available as discs for installation between two flanges.

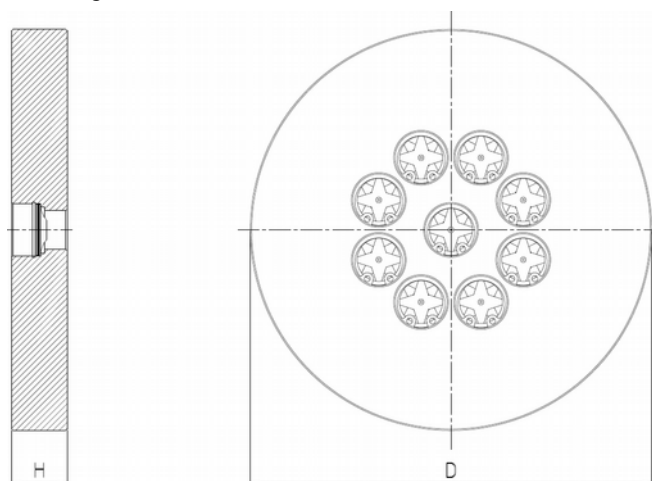

Nominal size	Norm	Number of regulating stars	Pressure range of the intermediate flange	Min. flow [l/min]	Max. flow [l/min]	H [mm]	D [mm]
DN 40	DIN / ASME	2	PN 16 / 300 lbs	2	60	19,1	95
DN 50	DIN	4	PN 16	4	120	18	110
DN 50	ASME	4	300 lbs	4	120	23,9	113
DN 65	DIN / ASME	7	PN 16 / 300 lbs	7	210	23,9	130
DN 80	DIN	9	PN 16	9	270	20,0	145
DN 80	ASME	9	300 lbs	9	270	23,9	150
DN 100	DIN	14	PN 16	14	420	20,0	165
DN 100	ASME	14	300 lbs	14	420	23,9	182